

### Syringe carriage assembly (4 pages)

Figure 1010-22

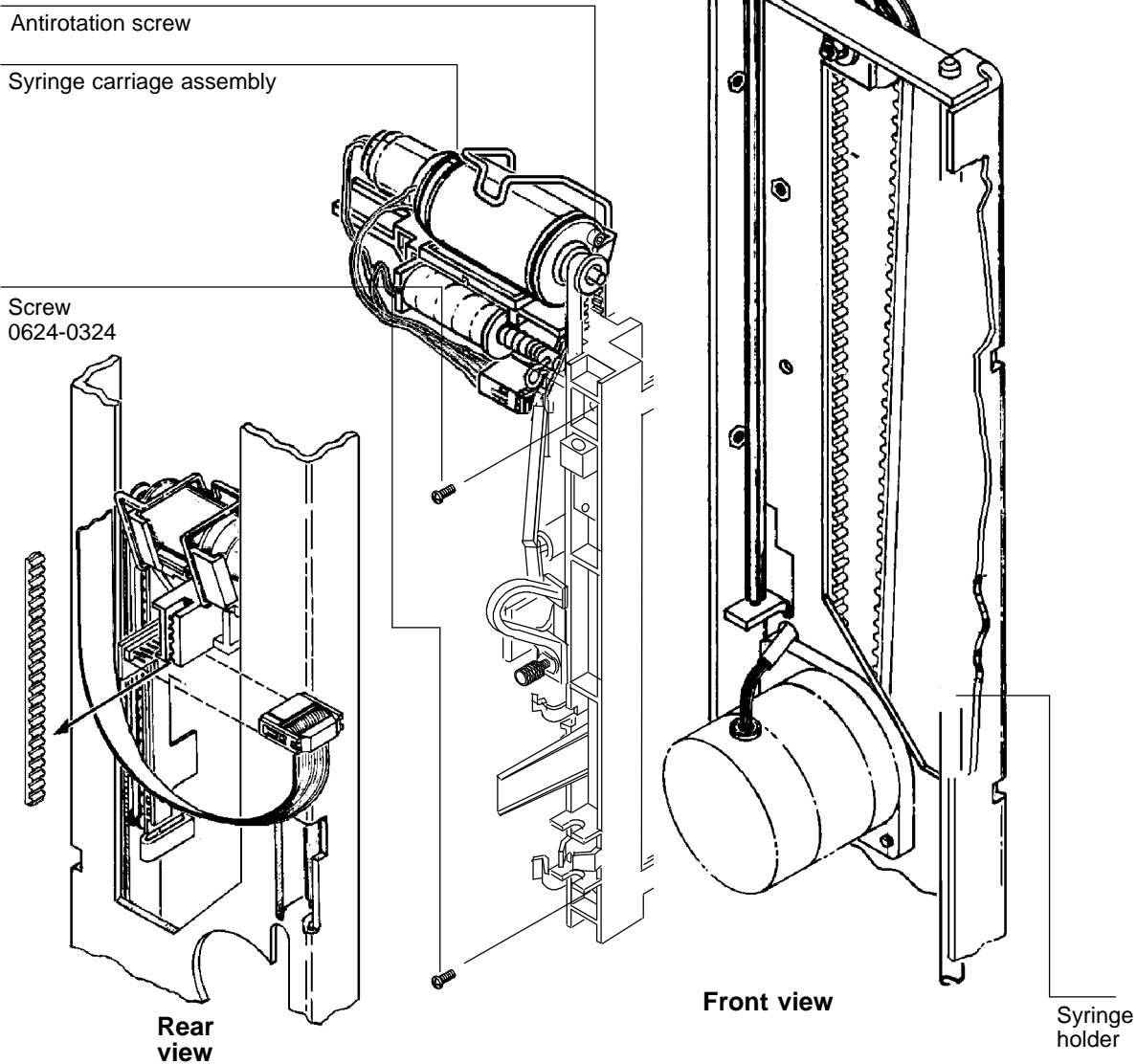

**Figure 1010-23**

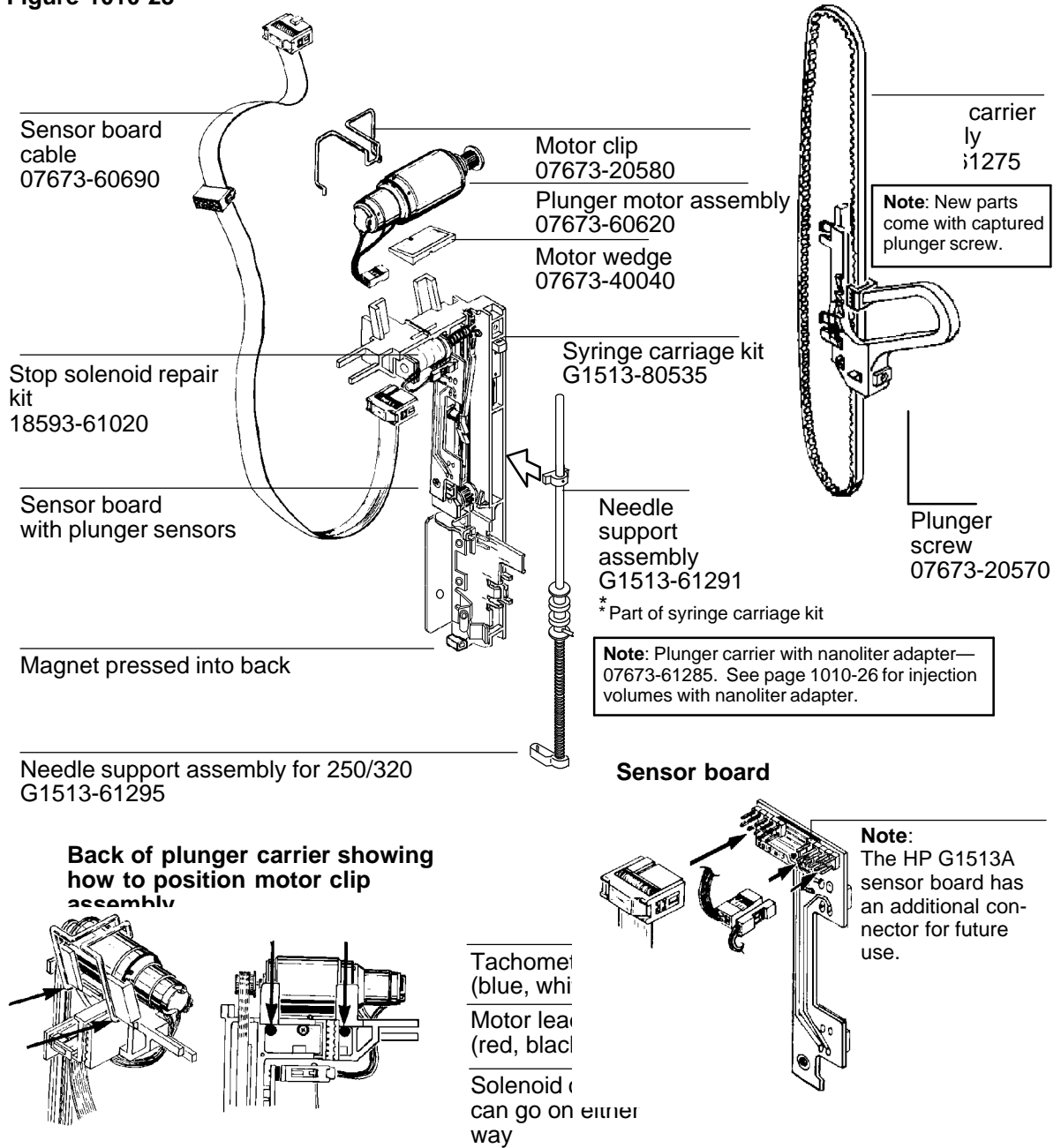

**250/320 automation upgrade kit**

For HP G1513A, use HP 18599T.

Setting	Sample Volume	Standard Injection		Nanoliter Injection	
	Syringe Size	5 $\mu$ l	10 $\mu$ l	5 $\mu$ l	10 $\mu$ l
1		0.5	1.0	0.1	0.2
2		1.0	2.0	0.5	1.0
3		1.5	3.0	1.0	2.0
4		2.0	4.0	1.5	3.0
5		2.5	5.0	2.0	4.0

**Figure 1010-24**

The foot of the needle support contains a replaceable needle guide made of plastic material. This guide should be replaced periodically. For high throughput labs, we recommend changing the guide every 6 months or 5000 injections.

**Caution:**

Matching the needle support and the cool on-column septum nut is crucial. Using the wrong septum nut or needle support will result in syringe needle bending problems and syringe carriage errors.

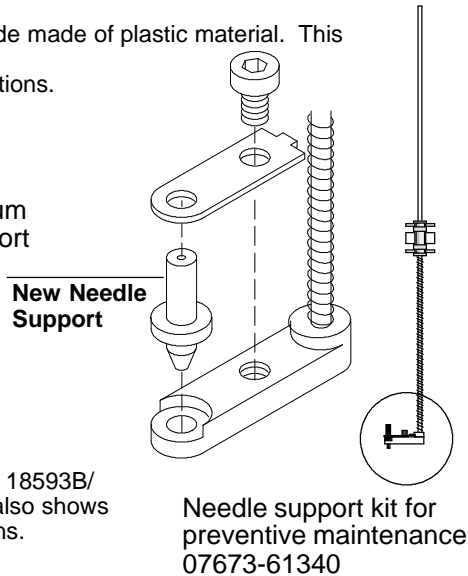

**Mounting the Injector over an On-Column Inlet**

The following table reviews the different parts for mounting an HP 18593B/ HP G1513A (post mount) injector over a cool on-column inlet. It also shows what is required for injection onto 0.32-mm to 0.25-mm i.d. columns.

**Type of GC/Injector/Column**

HP 5890 Series II cool on-column inlet and B (post mount) injector, and 0.53-mm i.d. column.

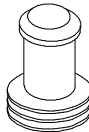

**Action Required**

Remove the needle guide (part number 19245-20670) from the septum nut base.



**Septum Nut Base Assembly 19245-80520**

HP 5890 Series II cool on-column inlet, B (post mount) injector configured to injector, and 0.32-mm to 0.25-mm columns.

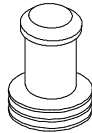

Use the small septum nut base assembly and 250/320 needle support.



**Small Septum Nut 19245-80521**

**Needle Support, 250/320 G1513-61295**



HP 5890A with cooling tower, B (post mount) injector, and 0.53-mm i.d. column.



Remove cooling tower and replace it with normal septum nut base assembly after aligning the bracket.



**Septum Nut Base Assembly 19245-80520**

**Cooling Tower 19245-20540**